



8TH & O STREETS, N.W.



WASHINGTON, DC

May 5th, 2017

PUD Re-submission

copyright, ©2016 | sba, PC

Street Level Rendering architects

shalom baranes associates architects A-11

ZONING COMMISSION
St. Louis, MO
CASE NO.16-24
EXHIBIT NO.26A3

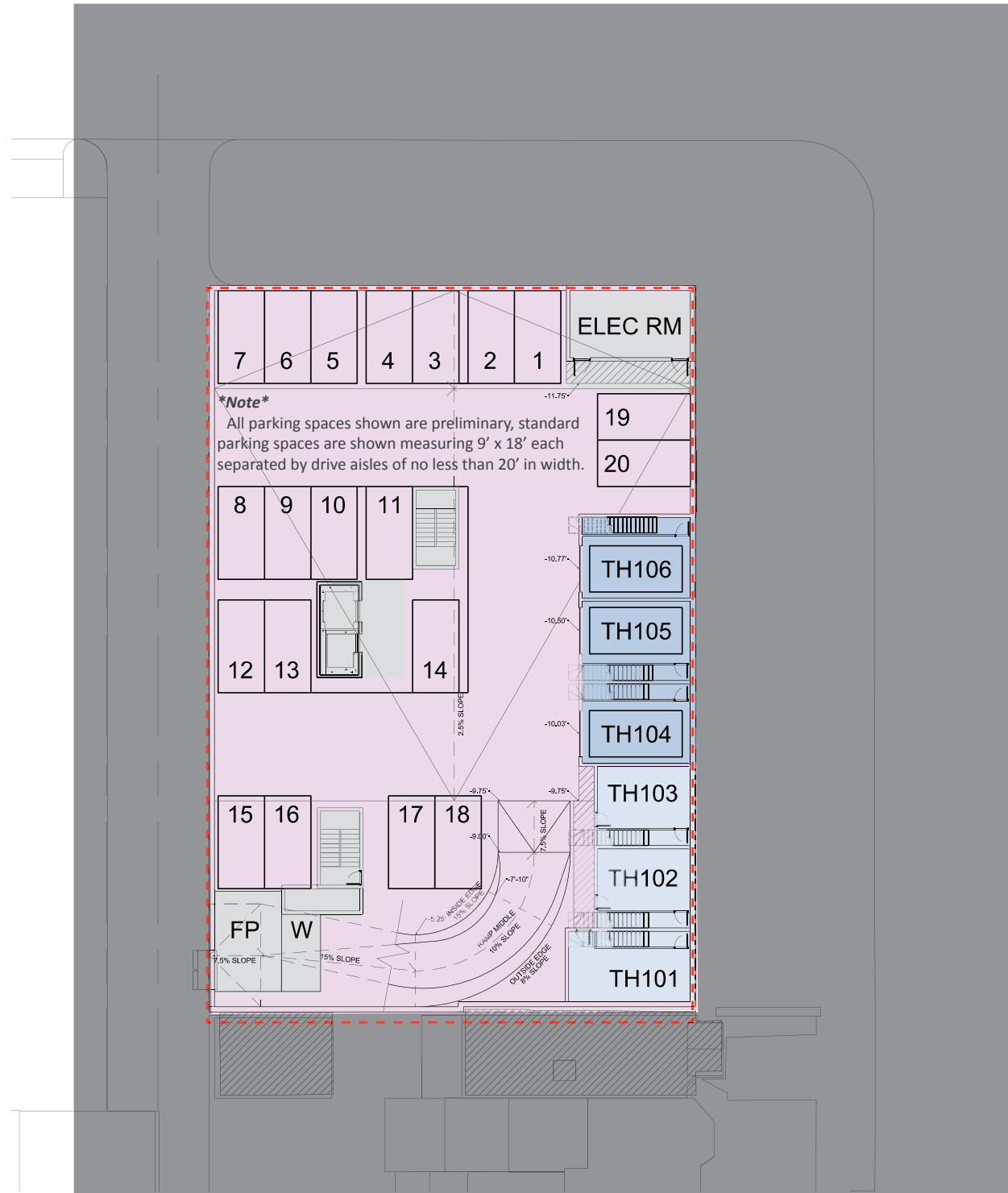

P1: Parking Level Demising Plan

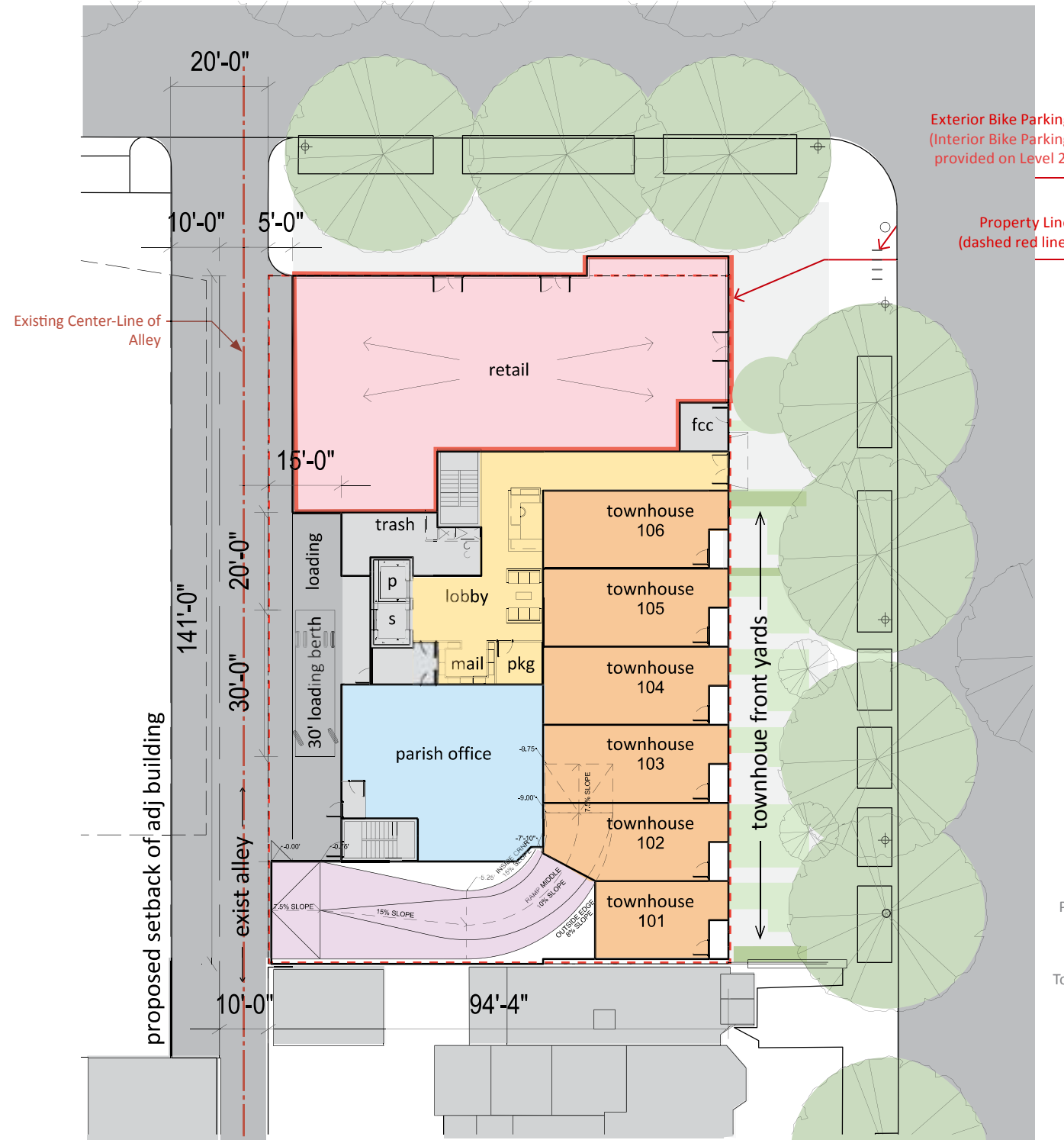
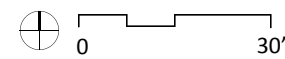

L1: Ground Level Demising Plan

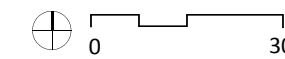

- *Notes***
- 1 - (A) designates affordable unit
 - 2 - Refer to Pages L-01 - L-02 for Landscape Drawings
 - 3 - Unit demising may change as unit layouts are developed

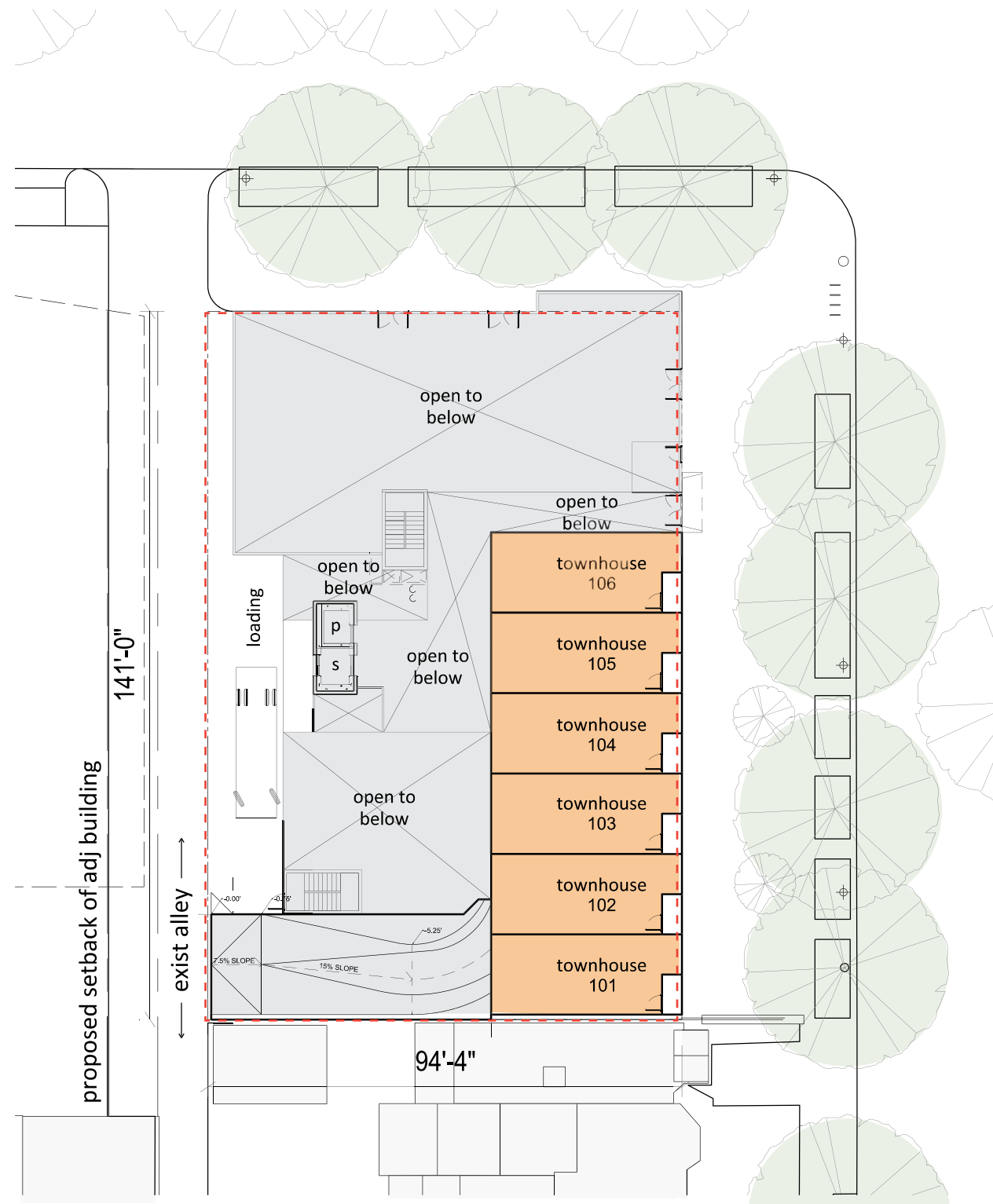

LM: Mezzanine Level Demising Plan

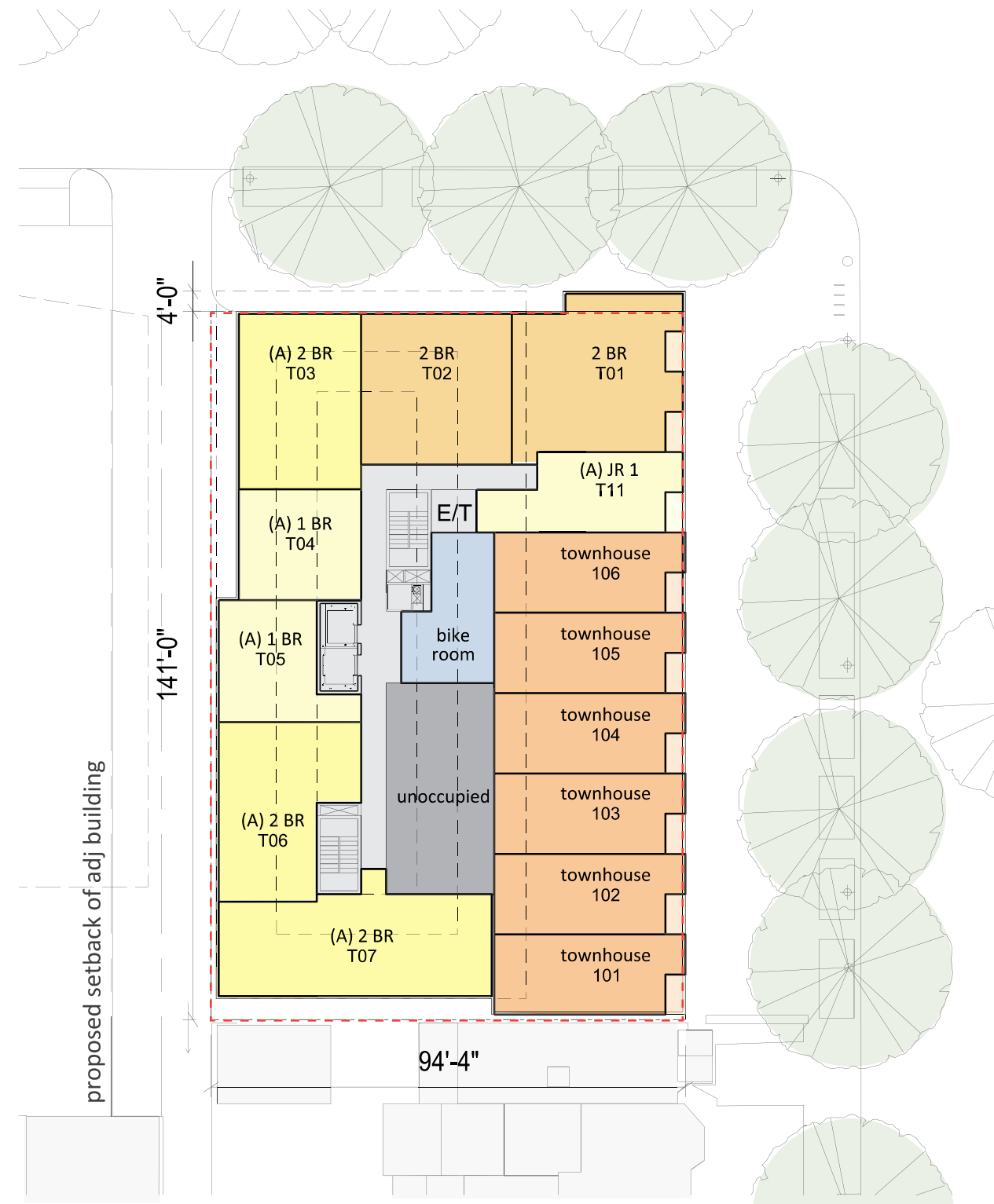
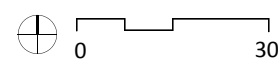

L2: Second Level Demising Plan

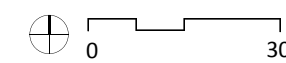

Key

- Parking
- Service
- Lobby
- Lobby
- Parish Hall
- Retail
- Townhouse
- (A) 1 BR
- (A) 2 BR
- 1 BR
- 2 BR

Notes

- 1 - (A) designates affordable unit
- 2 - Refer to Pages L-01 - L-02 for Landscape Drawings
- 3 - Unit demising may change as unit layouts are developed

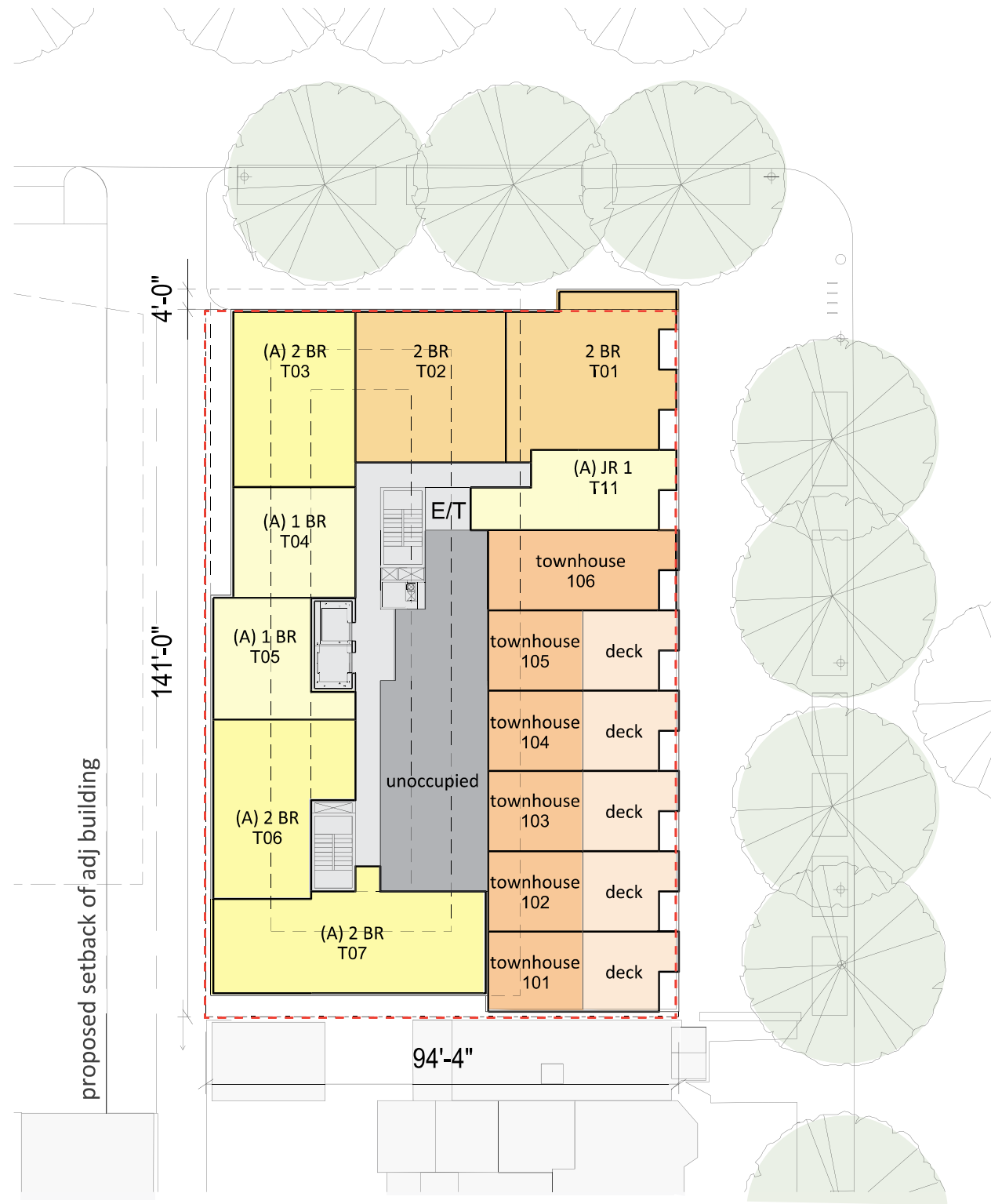

L3: Third Level Demising Plan

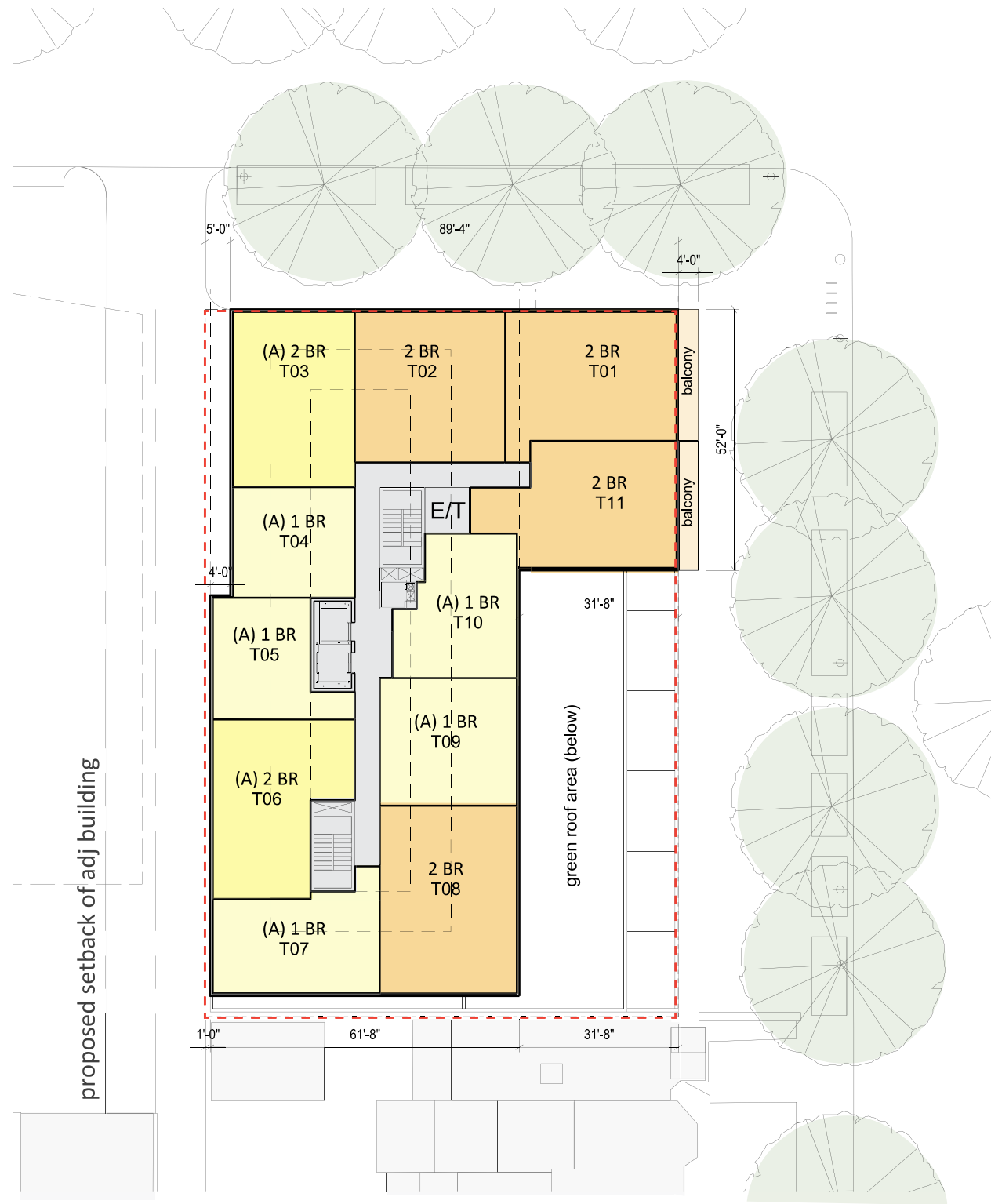
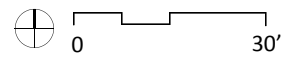

L4: Fourth Level Demising Plan

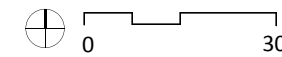

Key

- Parking
- Service
- Lobby
- Lobby
- Parish Hall
- Retail
- Townhouse
- (A) 1 BR
- (A) 2 BR
- 1 BR
- 2 BR

Notes
 1 - (A) designates affordable unit
 2 - Refer to Pages L-01 - L-02 for Landscape Drawings
 3 - Unit demising may change as unit layouts are developed

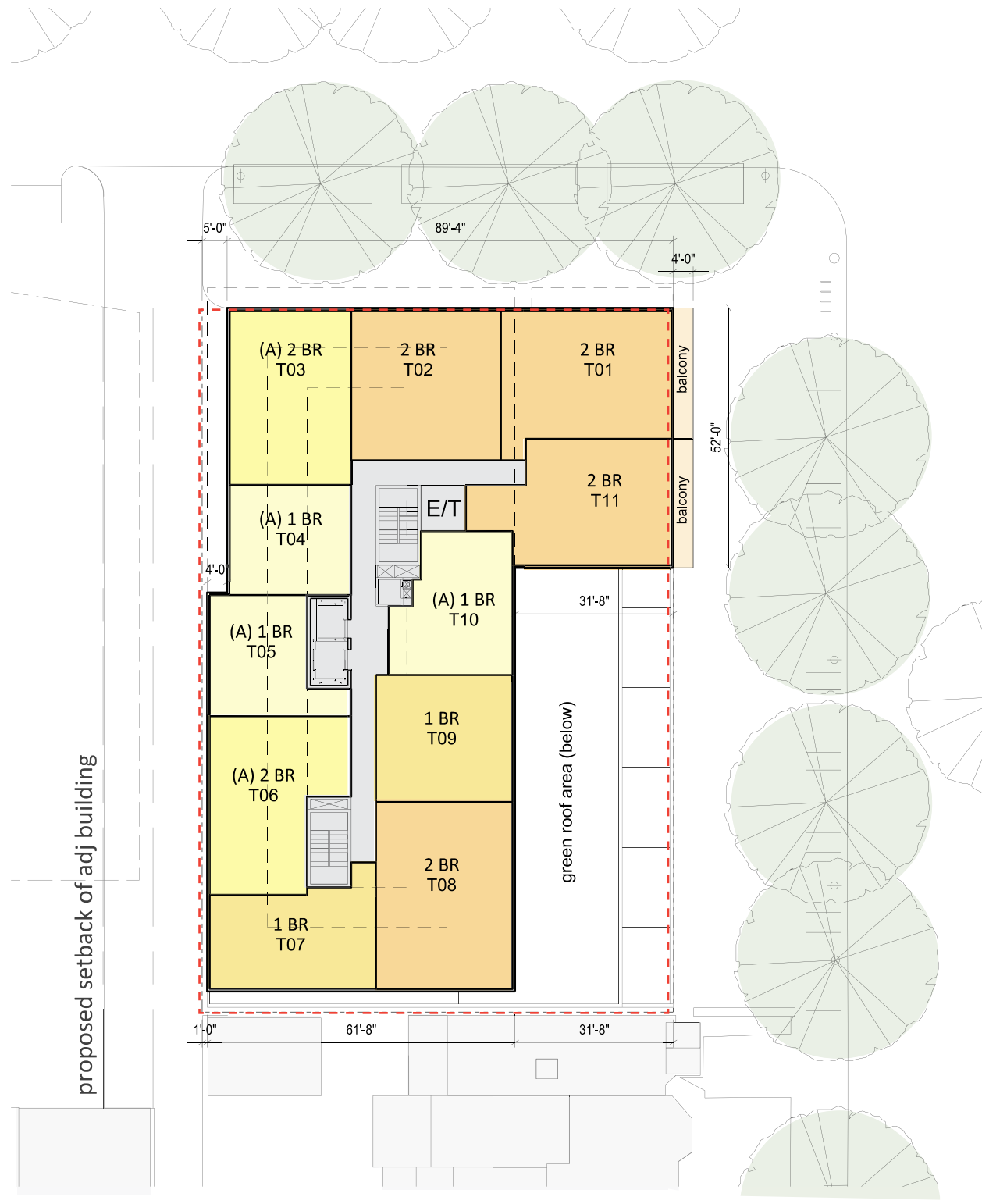

L5: Fifth Level Demising Plan

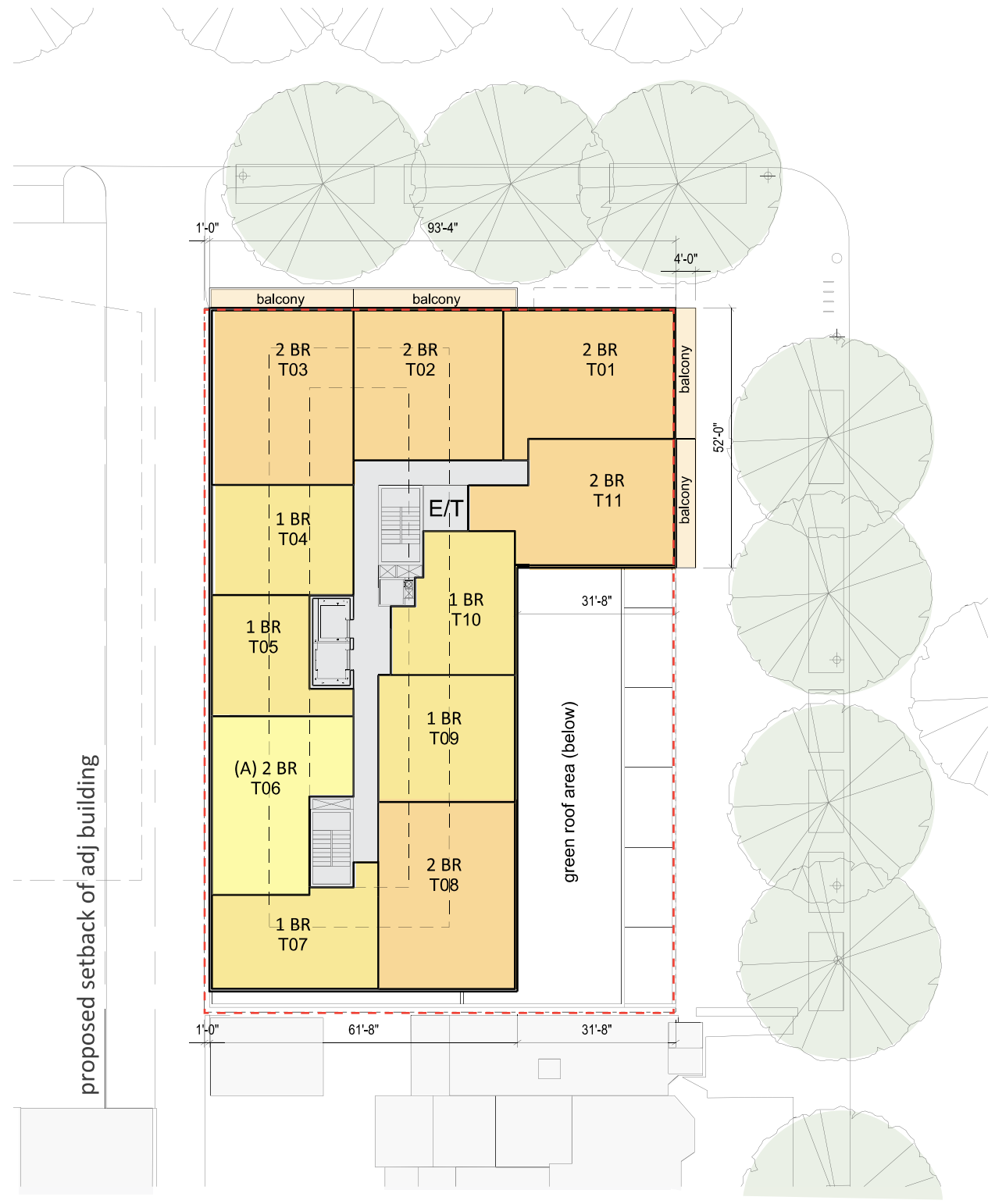
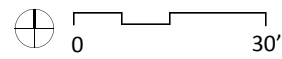

L6: Sixth Level Demising Plan

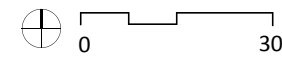

Key

- Parking
- Service
- Lobby
- Lobby
- Parish Hall
- Retail
- Townhouse
- (A) 1 BR
- (A) 2 BR
- 1 BR
- 2 BR

Notes
 1 - (A) designates affordable unit
 2 - Refer to Pages L-01 - L-02 for Landscape Drawings
 3 - Unit demising may change as unit layouts are developed